

Add shims 115625 between pos. 33 and 39 to ensure the axial position of motor coupling before mounting motor; removed after mounting motor and tighten pos. 37 to lift up the pump rotor

SECTION A-A

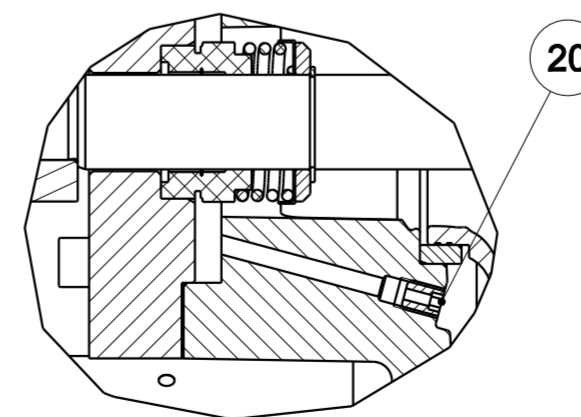

A.3 TIGHTENING TORQUE FOR POS. 40:

MOTOR SIZE	SCREW TORQUE	SCREW DIM.
80	10 Nm	M6
90	24 Nm	M8
100/112	24 Nm	M8
132	24 Nm	M8
160	24 Nm	M8

All dimensions are in mm unless otherwise specified.
 Remove burrs. Break sharp edges. Non-stated tolerances acc. to: EN 22768-mK (machined parts), EN ISO 13920-BF (welded parts), ISO 8062-CT10 (casted parts) max. mismatch 1 mm and acc. to quality instruction Q1314.

Drawn		Scale	1:2
Checked		ASSEMBLY FOR TSLH/-12	
Process		Revision	Description of Revision
Approved		Date	ADD TORQUE TABLE FOR POS. 40
State		Drawing No.	422801

DESMI

www.desmi.com
 © DESMI
 ALL RIGHTS RESERVED

Hist.Rev.	Description of Revision	Released date
A.2	UPDATE MODEL	2020.10.19
A.1	NEW CREATED	2020.09.11